

LIFTECH

LIFTECH Air / Hydraulic Truck Jacks

Part Number
YAJ-20C, YAJ-4

SPECIFICATIONS	YAJ-20C	YAJ-40B
Capacity	20,000kg	40,000kg
Closed Height	205mm	215mm
Aux Screw Height	105mm	74mm
Hydraulic Lift	120mm	100mm
Maximum Height	430mm	390mm
Adaptors (optional)	60mm or 100mm	60mm or 100mm
Overall Length	511mm	589mm
Overall Height with Handle	1430mm	1142mm
Overall Width	326mm	363mm
YAJ-20C Lifting Time	with 20,000kg load at air pressure 10kg/cm ² = 120 seconds	
YAJ-40B Lifting Time	with 40,000kg load at air pressure 10kg/cm ² = 200 seconds	
Air Pressure	6 ~ 10kg/cm ²	26 ~ 10kg/cm ²
Compressor Power	2.2kw(3psi)	3.7kw(5psi)
Net Weight	46kg	65kg

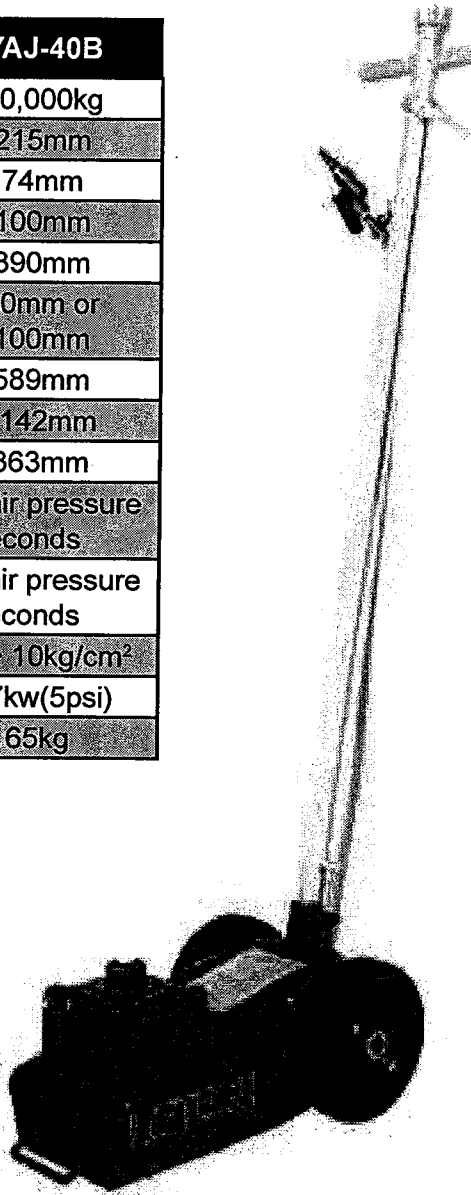
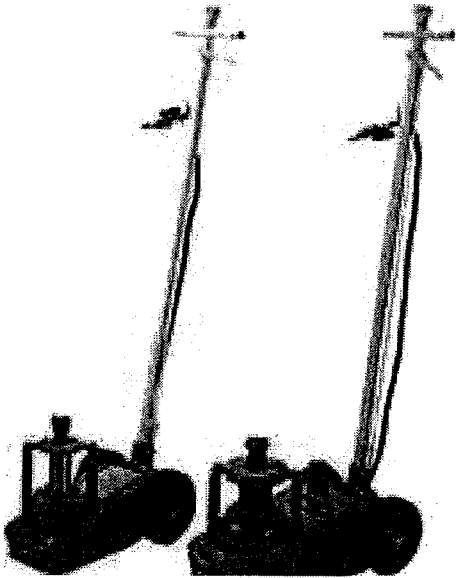

Air Hydraulic Garage Jack

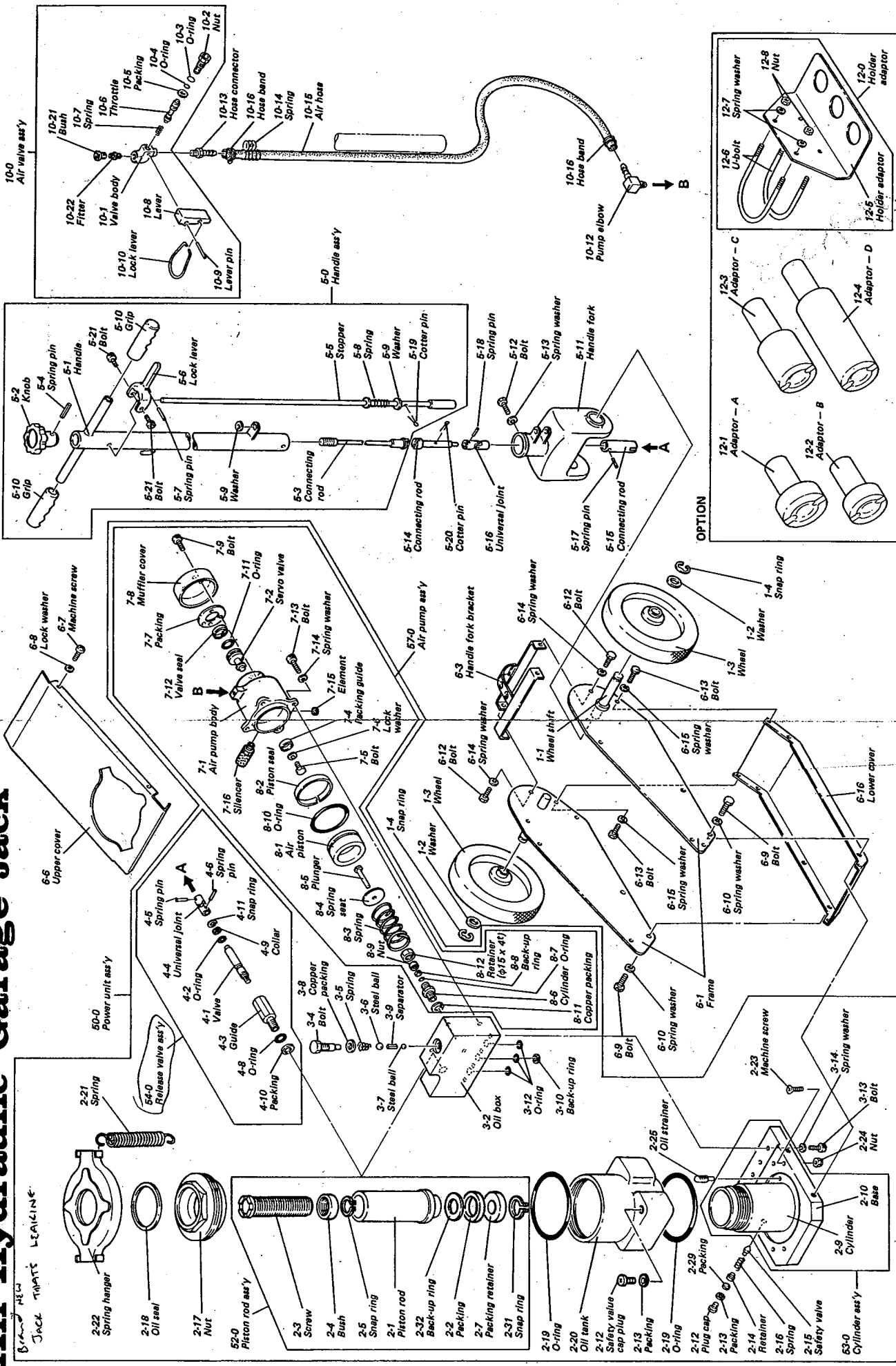

NOTE: EXHAUST



YAJ-20C

HEAD OFFICE
& EXPORT OFFICE
PLANT

YASUJI CORPORATION
2-17, 1 CHOME, HIGASHI-SHINBASHI, MINATO-KU, TOKYO, JAPAN
3711, MANNOHARA-SHINDEN, FUJINOMIYA-SHI, SHIZUOKA-KEN, JAPAN
TEL: (03) 3574-0651
TEL: (0544) 23-1221
1291 Printed in Japan

REPAIR PARTS LIST

Part No.	Part Name	Qty/set
1-1	Wheel shaft	2
1-2	Washer	2
1-3	Wheel	2
1-4	Snap ring	2
2-1	Piston rod ass'y	1
2-1	● Piston rod(1 piece)	
2-2	● Packing(1 piece)	
2-3	● Screw(1 piece)	
2-4	● Bush(1 piece)	
2-5	● Snap ring(1 piece)	
2-7	● Packing retainer(1 piece)	
2-8	Cylinder	1
2-12	Bolt	2
2-13	Packing	2
2-14	Spring retainer	1
2-15	Safety valve	1
2-16	Spring	1
2-17	Nut	1
2-18	Oil seal	1
2-19	O-ring	1
2-20	Oil tank	2
2-21	Spring	1
2-22	Spring hanger	4
2-23	Machine screw	1
2-24	Nut	4
2-25	Oil strainer	4
2-26	Packing	1
2-27	Snap ring	1
2-28	Back-up ring	1
3-2	Oil box	1
3-4	Bolt	1
3-5	Spring	1
3-6	Steel ball	1
3-7	Steel ball	1
3-8	Copper packing	1
3-9	Separator	1
3-10	Back-up ring	1
3-12	O-ring	1
3-13	Bolt	3
3-14	Spring washer	3
4-0	Release valve ass'y	1
4-1	● Valve(1 piece)	
4-2	● O-ring(1 piece)	
4-3	● Guide(1 piece)	
4-4	● Universal joint(1 piece)	
4-5	● Spring pin(1 piece)	
4-6	● Spring pin(1 piece)	
4-7	● O-ring(1 piece)	
4-8	● Washer(1 piece)	
4-10	● Packing(1 piece)	
4-11	● Snap ring(1 piece)	
5-0	Handle ass'y	1
5-1	● Handle(1 piece)	
5-2	● Knob(1 piece)	
5-3	● Connecting rod(1 piece)	
5-4	● Spring pin(1 piece)	
5-5	● Stopper(1 piece)	
5-6	● Lock lever(1 piece)	
5-7	● Spring pin(1 piece)	
5-8	● Spring(1 piece)	
5-9	● Washer(3 pieces)	
5-10	● Handle fork(1 piece)	
5-11	● Bolt(1 piece)	
5-12	● Spring washer(1 piece)	
5-13	● Connecting rod(1 piece)	
5-14	● Connecting rod(1 piece)	
5-15	● Universal joint(1 piece)	
5-16	● Spring pin(1 piece)	
5-17	● Spring pin(1 piece)	
5-18	● Cotter pin(1 piece)	
5-19	● Cotter pin(1 piece)	
5-20	● Bolt(2 pieces)	
6-1	Frame	1 set
6-3	Handle fork bracket	1
6-6	Upper cover	1
6-7	Machine screw	1
6-8	Lock washer	4
6-9	Bolt	4
6-10	Bolt	4
6-11	Bolt	4
6-12	Bolt	4
6-13	Spring washer	4
6-14	Lower cover	1

Part No.	Part Name	Qty/set
7-0	Air Pump ass'y	1
7-1	● Air pump body(1 piece)	
7-2	● Servo valve(1 piece)	
7-3	● Packing(1 piece)	
7-4	● Packing guide(1 piece)	
7-5	● Bolt(1 piece)	
7-6	● Lock washer(1 piece)	
7-7	● O-ring(1 piece)	
7-8	● Muffler cover(1 piece)	
7-9	● Bolt(4 pieces)	
7-10	● Lock washer(4 pieces)	
7-11	● Packing(1 piece)	
7-12	● Bolt(4 pieces)	
7-13	● Spring washer(4 pieces)	
7-14	● Plate(1 piece)	
7-15	● Screw(2 pieces)	
7-16	● Spring washer(2 pieces)	
7-17	● Plug(1 piece)	
7-18	● Washer(4 pieces)	
7-19	● Spring washer(2 pieces)	
7-20	● Spring washer(2 pieces)	
7-21	● Plug(1 piece)	
7-22	● Washer(4 pieces)	
8-1	Air piston	1
8-2	Packing	1
8-3	Spring	1
8-4	Spring retainer	1
8-5	Plunger	1
8-6	Cylinder	1
8-7	O-ring	1
8-8	Back-up ring	1
8-9	Nut	1
8-11	Packing	1
8-12	Back-up retainer	1
10-00	Air valve ass'y	1
10-1	● Valve body(1 piece)	
10-2	● Nut(1 piece)	
10-3	● O-ring(1 piece)	
10-4	● O-ring(1 piece)	
10-5	● Packing(1 piece)	
10-6	● Throttle(1 piece)	
10-7	● Spring(1 piece)	
10-8	● Lever(1 piece)	
10-9	● Lever pin(1 piece)	
10-10	● Lock lever(1 piece)	
10-11	● Pump elbow(1 piece)	
10-12	● Hose connector(1 piece)	
10-13	● Spring(1 piece)	
10-14	● Air hose(1 piece)	
10-15	● Hose band(2 pieces)	
10-16	● Filter(1 piece)	
10-17	● Bush(1 piece)	
10-18	● Plug(1 piece)	
10-19	● Plug(1 piece)	
10-20	● Plug(1 piece)	
10-21	● Plug(1 piece)	
10-22	● Plug(1 piece)	
10-23	● Plug(1 piece)	
10-24	● Plug(1 piece)	
10-25	● Plug(1 piece)	
10-26	● Plug(1 piece)	
10-27	● Plug(1 piece)	
10-28	● Plug(1 piece)	
10-29	● Plug(1 piece)	
10-30	● Plug(1 piece)	
10-31	● Plug(1 piece)	
10-32	● Plug(1 piece)	
50-0	Power unit ass'y	1
12-0	Holder adaptor ass'y (OPTION)	1
12-1	● Adaptor-A(1 piece)	
12-2	● Adaptor-B(1 piece)	
12-3	● Adaptor-C(1 piece)	
12-4	● Adaptor-D(1 piece)	
12-5	● Holder adaptor(1 piece)	
12-6	● U-Bolt(2 pieces)	
12-7	● Nut(4 pieces)	
12-8	● Spring washer(4 pieces)	

REPAIR KITS		
Part No.	Part Name	Qty/set
2-2	Packing	1
2-13	Packing	2
2-19	O-ring	2
3-12	O-ring	3
4-2	O-ring	1
4-3	O-ring	1
4-10	Packing	1
7-11	Packing	1
8-2	Packing	1
8-7	O-ring	1
8-8	Back-up ring	1
8-11	Packing	1
10-3	O-ring	1
10-4	O-ring	1
10-5	Packing	1

The above parts are subject to change without notice. 0002

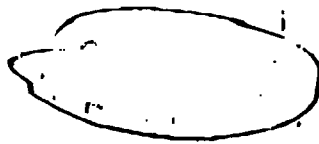

YAT 20c

ILLUSTRATED PARTS-BREAKDOWN SHEET OF PLASTIC AIR PUMP FOR 20(22)TON CAPACITY AIR HYDRAULIC JACK

7.0 ASSEMBLY

8-2 Piston seal

8-1 Air piston

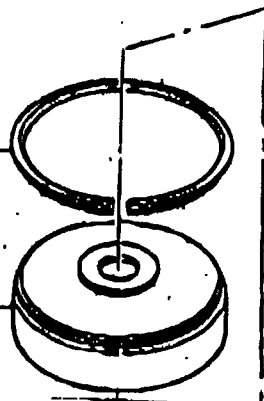

ATTN: CATHY
FAX: 02.97711260
FROM: MICHAEL.

